

— THE ART  
OF *PROJECT*

ISSUE No 7 - 2024

SHĀKE

LIVING 4 - 35

DINING 36 - 53

KITCHEN 54 - 85

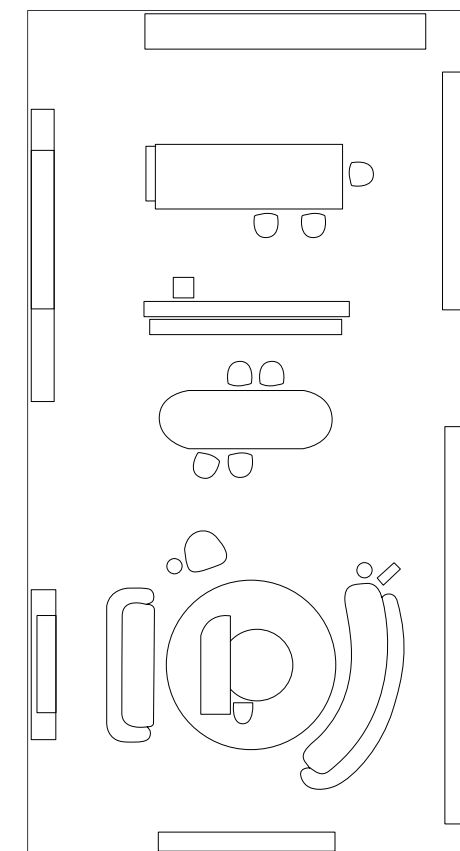

SHAKE DESIGN THE ART OF PROJECT

*IT - Shake propone un progetto estremamente coordinato composto da living, dining e kitchen. Gli arredi si inseriscono in questa continuità di spazio dove creano degli accenti di forte contrasto grazie all'accostamento di diversi materiali e superfici luminose. I colori chiari e neutri esaltano le forme decise e originali dei prodotti come in una vera opera d'arte.*

*EN - Shake proposes an extremely coordinated design consisting of living, dining and kitchen. The furnishings fit into this continuity of space where they create strong contrasting accents through the combination of different materials and luminous surfaces. The light, neutral colours enhance the strong, original shapes of the products as in a true work of art.*

LIVING 4 - 35

TABLE MAYFAIR

CHAIR EGO

DAY SYSTEM TIME

CURVED SOFA VOGUE

SOFA VOGUE

ARMCHAIR FUN

ROUND COFFEE TABLE CAPRI

COFFEE TABLE EGO

SIDE TABLE NO NAME

SMALL TABLE HEX

SMALL TABLE VICTOR

MIRROR MOON

DAY SYSTEM ELLE

BASES COMPOSITION MAYFAIR

WALL-HANGING BOOKCASE HEGE

WALL PANNELLING TAMI

CEILING LAMP CAGE

FLOOR LAMP WEVE

WALL LAMP LINE



LIVING

DIVANO CURVATO VOGUE CON BASAMENTO  
IN LEGNO T166 DESERT. SEDUTA,  
SCHIENALE E CUSCINI DECORATIVI  
IMBOTTITI E RIVESTITI IN TESSUTO  
F30 NPL COL. 0357 CREME cm L  
427,5 x P 136/185,5 x H 75 / CURVED  
SOFA VOGUE WITH BASE IN WOOD  
T166 DESERT. SEAT, BACKREST  
AND DECORATIVE CUSHIONS PADDED  
AND UPHOLSTERED WITH FABRIC  
F30 NPL COL. 0357 CREME cm L  
427,5 x W 136/185,5 x H 75





LIVING

IT -In questa pagina poltrone Fun con schienale curvo in legno T150 noir e base M07 titanio.  
Bracciolo in metallo verniciato M07 titanio con elementi decorativi in legno T150 noir. Seduta e  
schienale imbottiti e rivestiti in pelle P46 nabuk liscio col.blu oceano cat. D. cm L 86 x P 80 x H 75  
EN - On this page Fun armchair with curved backrest in wood T150 noir and base M07 titanio.  
Armrest in metal M07 titanio with decorative elements in wood T150 noir. Seat and backrest padded  
and upholstered with leather P46 nubuck plain col. blu oceano cat. D. cm L 86 x W 80 x H 75



LIVING



LAMPADARI A SOSPENSIONE CAGE CON PIASTRA SUPERIORE, PIASTRA INFERIORE E GRIGLIA IN METALLO NICKEL NERO SPAZZOLATO. CILINDRO FINITURA "COCOON". cm Ø40/50 x H106 / CEILING LAMPS CAGE WITH TOP PLATE, BOTTOM PLATE AND FRAME IN VARNISHED METAL BLACK BRUSHED NICKEL. CYLINDER WITH "COCOON" FINISH. cm Ø40/50 x H106







IT - In questa pagina composizione di tavolini, partendo da sinistra tavolino Ego con gambe in legno M07 titanio e top in legno in finitura Calce col. bianco cm L 200 x P 60 x H 30, tavolino rotondo Capri con una gamba cilindrica in legno M07 titanio ed una dritta in vetro bronzo, top in marmo Breccia Capraia levigato e vetro bronzo cm Ø 140 x 36 H, tavolino Noname con struttura in legno e basamento in metallo C165 laccato petrolio lucido cm L 40 x P 40 x H 45,4.

EN - On this page coffee tables composition, from the left Ego coffee table with legs in wood M07 titanio, top in wood finish Calce col.bianco, Capri round coffee table with one cylindrical base in wood M07 titanio and one straight leg in bronze glass, top in marble Breccia Capraia honed and bronze glass cm Ø 140 x 36 H and Noname side table with structure in wood and base in metal C165 lacquered petrolio glossy cm L 40 x P 40 x H 45,4.lacquered petrolio glossy.





LIVING

DETTAGLIO SU TOP CAPRI IN VETRO BRONZO  
E MARMO BRECCIA CAPRAIA LEVIGATO /  
DETAILS ON CAPRI TOP IN BRONZE GLASS  
AND MARBLE BRECCIA CAPRAIA HONED.



SPECCHIERA MOON CON MEZZALUNA IN  
LEGNO M02 BRONZO SCURO, SPECCHIO FUMÈ  
E BARRA IN METALLO M02 BRONZO SCURO  
cm Ø 200 / MOON MIRROR WITH ELEMENT IN  
WOOD M02 DARK BRONZE, SMOKED MIRROR  
AND METAL BAR M02 DARK BRONZE cm Ø 200





IT - In queste pagine divano dritto Vogue con  
basamento in legno T166 Desert, seduta, schienale  
e cuscini decorativi imbottiti e rivestiti in pelle P90  
amal col. 315 cat. C cm L 317 x P 103,5 x H 75  
EN - On this pages Vogue straight sofa with base  
in wood wood T166 Desert, seat, backrest and  
decorative cushions padded and upholstered with  
leather P90 amal col. 315 cat. C cm L 317 x W  
103,5 x H 75

LIVING

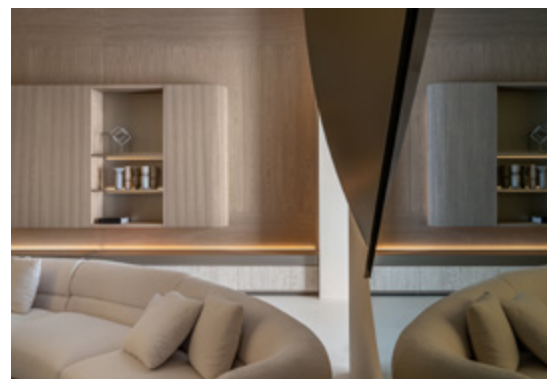



LIVING

DIVANO VOGUE CON BASAMENTO IN  
LEGNO, SEDUTA E SCHIENALE IMBOTTITI E  
RIVESTITI IN PELLE / VOGUE SOFA WITH  
BASE IN WOOD WOOD, SEAT AND BACKREST  
PADDED AND UPHOLSTERED WITH LEATHER.

## LIVING

IT - In queste pagine sistema giorno Elle con struttura ed interni in legno T166 Desert, divisori M07 titanio e T166 Desert in legno. Cestone in legno in finitura M07 titanio (interni T166 Desert), anta in vetro bronzo con inserto legno M07 titanio. Lampade/divisori luminosi in vetro ed illuminazione led integrata 3000K luce calda. A completamento: set in marmo Travertino poro aperto e griglie in metallo M07 titanio cm L 200 x P 41/45 x H 396,5.

EN - On this pages Elle day system with structure and interiors in wood T166 Desert, dividers in wood M07 titanio and T166 Desert. Wooden drawer M07 titanio (interiors T166 Desert), bronze glass door with wooden insert M07 titanio. Lamps/dividers in glass and integrated led lighting 3000K warm white. Marbles sets in Travertino open pore and metal grids M07 titanio cm L 200 x W 41/45 x H 396,5.







## LIVING

IT - In queste pagine: 3 basi Mayfair con top, sotto-top e gambe in legno T166 Desert. Cornice perimetrale su top in legno M07 titanio. Finitura interni in legno T166 Desert. Frontali cassetti in marmo Travertino poro aperto rigato. Retroilluminazione led. cm L 300+200+300 x P 51,5 x H 50. Applique Line in metallo verniciato nickel nero spazzolato cm L 8,4 x P 7 x H 220.

EN - On this pages: 3 wooden bases Mayfair with top, under-top and legs in wood T166 Desert. Top perimeter frame in wood M07 titanio. Interiors in wood T166 Desert. Drawer fronts in marble Travertino striped. Led backlighting. cm L 300+200+300 x W 51,5 x H 50. Line wall lamp in varnished metal black brushed nickel cm L 8,4 x W 7 x H 220.

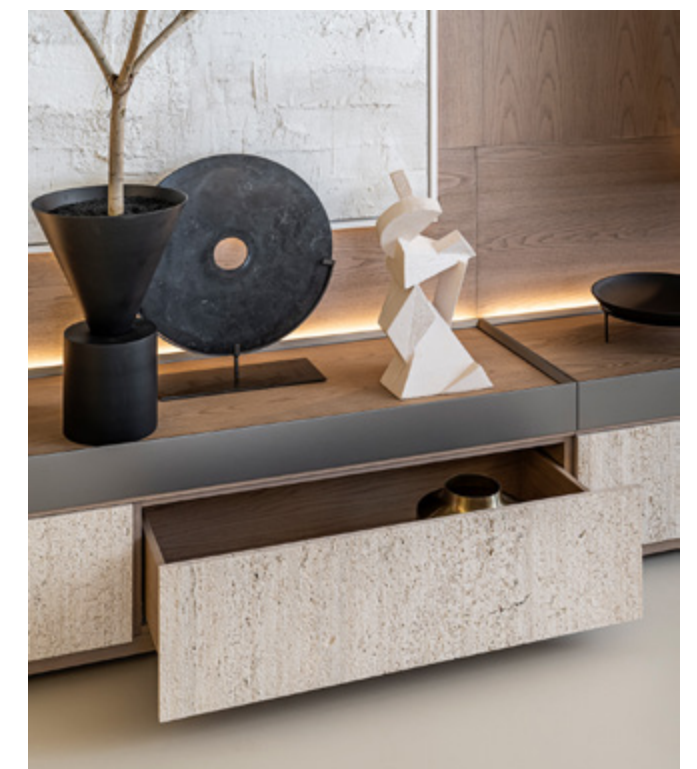







## LIVING

IT - In queste pagine: libreria pensile Hege con struttura e 3 ante battenti con decoro cannettato HEGE in legno T166 Desert. Vano a giorno con schienale e ripiani in legno M07 titanio. Interni in legno T166 Desert. Illuminazione led su retro schienale/fianchi ed illuminazione integrata interna, luce calda 2700 K cm L 318,5 x P 40 x H 183

Boiserie Tami con pannelli di finitura in legno T166 Desert e profilo perimetrale M07 titanio.  
 EN - On this pages: Hege wall-hanging bookcase with structure and 3 hinged doors in wood with fluted design HEGE in wood T166 Desert. Open compartment with back and shelves in wood M07 titanio. Interiors in wood T166 Desert. Back/sides with 2 led profiles behind halo effect and internal integrated led lighting 2700K warm white cm L 318,5 x W 40 x H 183  
 Tami frontal finishing panel in wood T166 Desert and perimeter profile in wood M07 titanio.



DINING 36 - 53

OVAL TABLE MAYFAIR

CHAIR EGO

DAY SYSTEM TIME



DINING

TAVOLO OVALE MAYFAIR CON STRUTTURA  
E TOP IN FRASSINO T166 DESERT / OVAL  
TABLE MAYFAIR WITH FRAME AND  
TOP IN ASH WOOD T166 DESERT



## DINING



IT - In queste pagine tavolo ovale Mayfair con struttura e top in frassino T166 Desert, parti sagomate del top e fianchi in marmo Breccia Capraia levigato, zoccolo in legno M07 titanio cm L 350 x P 120 x H 76,5.

Sedia Ego con struttura in metallo M07 titanio e legno T166 Desert, seduta e cuscino schienale imbottiti e rivestiti in pelle P90 amal col. 315 cat. C cm L 64,7 x P 52,2 x H 80

EN - Oval table Mayfair with frame and top in ash wood T166 Desert, shaped parts of top and sides in marble Breccia Capraia honed, plinth in wood M07 titanio cm L 350 x P 120 x H 76,5.

Ego chair with frame in metal M07 titanio and wood T166 Desert, seat and backrest cushion padded and upholstered with leather P90 amal col. 315 cat. C cm L 64,7 x P 52,2 x H 80.

IT - Dettaglio lavorazione curva della gamba del tavolo ovale Mayfair in marmo Breccia Capraia levigato e frassino T166 Desert.

EN - Details on curved manufacturing leg of Mayfair oval table in marble Breccia Capraia honed and ash wood T166 Desert.



FOCUS SULLA GAMBA DEL TAVOLO MAYFAIR  
CON ZOCCOLO IN LEGNO M07 TITANIO  
/ FOCUS ON MAYFAIR TABLE LEG WITH  
PLINTH IN WOOD M07 TITANIO.

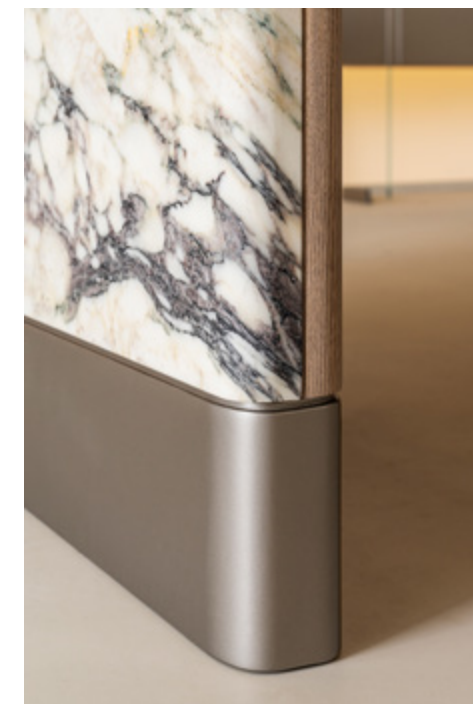

## DINING

IT - In queste pagine sedia Ego con Struttura in metallo M07 titanio e legno T166 Desert, seduta e cuscino schienale imbottiti e rivestiti in pelle P90 amal col. 315 cat. C cm L 64,7 x P 52,2 x H 80

EN - On this pages Ego chair with frame in metal M07 titanio and wood wood T166 Desert, seat and backrest cushion padded and upholstered with leather P90 amal col. 315 cat. C cm L 64,7 x P 52,2 x H 80.







DINING

SISTEMA GIORNO TIME CON STRUTTURA IN  
VETRO EXTRACHIARO E BOX IN LEGNO T166  
DESERT / TIME DAY SYSTEM WITH  
STRUCTURE IN EXTRA CLEAR GLASS AND  
BOXES IN WOOD WOOD T166 DESERT.

## DINING

IT - In queste pagine: sistema giorno Time con struttura e ripiani in vetro extrachiario con inserti in metallo M07 titanio, elementi decorativi verticali e ripiani in legno T166 Desert. Box in legno T166 Desert con n.3 ante a ribalta, n.1 anta battente, fianchi e schiene in legno M07 titanio cm L 405 x P 38,2 x H 400

EN - On this pages Time day system with structure and shelves in extra clear glass with metal inserts M07 titanio. Vertical decorative elements and shelves in wood T166 Desert. Wooden box T166 Desert with 3 flap doors and 1 hinged door, sides and backs in wood M07 titanio cm L 405 x W 38,2 x H 400



DETTAGLI SU SISTEMA GIORNO TIME CON  
ELEMENTI DECORATIVI VERTICALI E RIPIANI  
IN LEGNO T166 DESERT / DETAILS ON TIME  
DAY SYSTEM WITH VERTICAL DECORATIVE  
ELEMENTS AND SHELVES IN WOOD T166 DESERT.



KITCHEN 54 - 85

KITCHEN COMPOSITION MILANO

KITCHEN ISLAND MILANO

WARDROBE LINE

DAY SYSTEM VOGUE

STOOL FRAME

CEILING LAMP WEVE

PARQUET VIEW



KITCHEN

ISOLA CUCINA MILANO CON PIANO DI LAVORO E  
FIANCO IN MARMO BRECCIA CAPRAIA LEVIGATO  
/ MILANO KITCHEN ISLAND WITH WORKTOP  
AND SIDE IN MARBLE BRECCIA CAPRAIA HONED.





IT - In queste pagine isola Milano: basi con cassettoni, frontali in acciaio con apertura push-pull (interi legno T166 Desert ). Pannello retrobancone in legno dogato T166 Desert con zoccolo M02 bronzo scuro, retroilluminato luce calda 2700K. Elemento curvato in acciaio con piano di lavoro e fianco in marmo Breccia Capraia levigato cm L 380 x P 110 x H 93/83,3  
EN - On this pages Milano kitchen island: drawers with fronts lined with steel, push-pull opening (interiors in wood T166 Desert). Back counter panel in slatted wood T166 Desert, with plinth M02 bronzo scuro, led profiles behind halo effect 2700K warm light, curved element in steel. Worktop and side in marble Breccia Capraia honed cm L 380 x W 110 x H 93/83,3.

## KITCHEN

IT - Dettaglio sui materiali in contrasto: piano di lavoro in marmo Breccia Capraia levigato e la base curvata in acciaio.  
EN - Details on contrast materials: worktop and side in marble Breccia Capraia honed with curved base in steel.

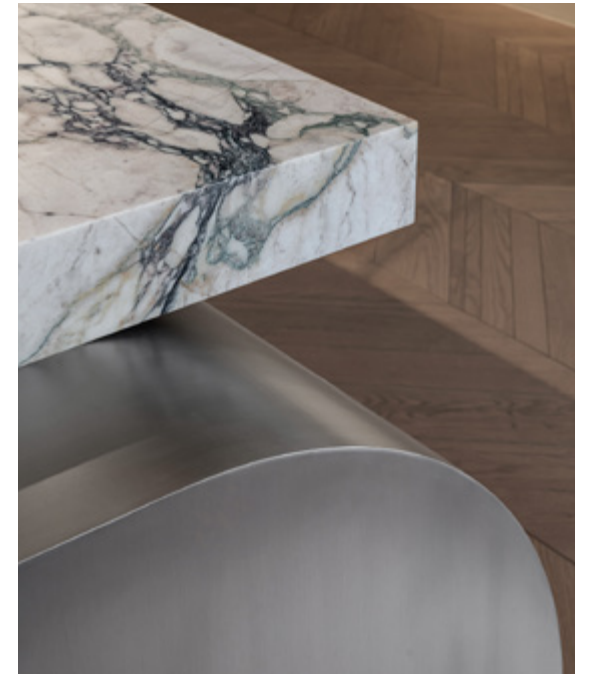

KITCHEN



KITCHEN

IT - L'isola Milano sul lato operativo è così composta: prima e terza base con n.2 cassettoni con frontali in acciaio, apertura push pull. Il cassettone superiore è attrezzato con cassetto interno con portaposate in rovere fiammato tinto moka e alluminio nero, seconda base con n.2 cassettoni con frontali in acciaio, apertura push pull, il cassettone inferiore attrezzato con fondo portapentole e portacoperchi in rovere fiammato tinto moka cm L 380 x P 110 x H 93/83,3

In queste immagini: sgabello Frame con struttura in metallo M07 titanio, seduta e schienale curvo in legno imbottiti e rivestiti in pelle P90 amal col. 315 cat. C cm L 50 x P 51 x H 85 cm e lampadario a sospensione Weve con telaio in metallo verniciato nickel nero spazzolato formato da tubo verticale e rosone a soffitto, 4 lampade fisse in metallo verniciato con opalino plexiglass colore bianco cm L 56,7 x H 150

EN - The Milano kitchen island, on the operative side is composed as follows: first and third base units with No. 2 drawers with steel fronts, push-pull opening. The upper drawer is equipped with inner drawer with cutlery holder in moka stained flamed oak and black aluminum, the second base unit has No. 2 drawers with steel fronts, push-pull opening, the lower drawer is equipped with pot and pan holder bottom in moka stained flamed oak.

In these images: Frame stool with M07 titanio metal frame, curved wooden seat and back padded and upholstered in leather P90 amal col. 315 cat. C L 50 x W 51 x H 85 cm and Weve ceiling lamp with varnished metal frame black brushed nickel composed of vertical tube and ceiling rosette, 4 fixed lamps in varnished metal with white opal plexiglass. cm L 56,7 x H 150





KITCHEN

COMPOSIZIONE CUCINA MILANO IN  
MARMO BRECCIA CAPRAIA LEVIGATO  
/ MILANO KITCHEN COMPOSITION IN  
MARBLE BRECCIA CAPRAIA HONED.

KITCHEN





IT - Composizione cucina Milano con piano di lavoro, lavabo, rivestimento murale ed elemento sottopensile in marmo Breccia Capraia levigato cm L 575 x P 72,5 / 87,5 x H 301,5  
Accessori interni in rovere fiammato tinto moka e alluminio anodizzato nero.  
EN - Milano kitchen composition with worktop, sink, backsplash and element under wall-hanging cupboards in marble Breccia Capraia honed cm L 575 x W 72,5 / 87,5 x H 301,5  
Internal accessories in moka stained oak and black anodized aluminium.



## KITCHEN

IT - Dettagli sul top in marmo, sottopensile con illuminazione integrata, luce calda 2700 K e canale attrezzato per accessori in alluminio verniciato nero.  
EN - Details on marble top, undercabinet with integrated lighting, warm light 2700 K and equipped frame for accessories in varnished aluminium black.





## KITCHEN

IT - Cucina Milano presenta pensili con ante battenti in legno finitura Calce col.bianco - apertura push pull, attrezzate con ripiani interni in legno T166 Desert; illuminazione interna con luce calda 2700, accensione con sensore all'apertura delle ante. Base estraibile con anta in legno finitura Calce col.bianco - apertura push pull, attrezzata con: n.1 cassettone interno in legno T166 Desert con tappetini antisdrucciolo col.antracite.

EN - Milano kitchen has wall-hanging cupboard with hinged doors in wood finish Calce col. bianco - push-pull opening, equipped with internal shelves in wood T166 Desert; internal lighting, 2700 warm light, switching on/off with doors opening. Pull-out base unit with wooden door in Calce col.bianco - push-pull opening, equipped with no.1 internal drawer in wood T166 Desert, anti-slip mats col.antracite.





## KITCHEN

IT - Composizione cucina Milano composta: a sinistra da una colonna con n.2 ante a rientrare in legno dogato finitura T166 Desert e maniglioni in M07 Titanio, attrezzata con: n.2 cassettoni con apertura maniglia a gola in M07 Titanio, vano per forno ad incasso, vani a giorno laterali e n.2 ripiani in vetro neutro extrachiaro - illuminazione interna luce calda 2700 K, accensione con sensore all'apertura delle ante. A destra, una colonna con n.2 ante a rientrare in legno dogato finitura T166 Desert e maniglioni in M07 Titanio, attrezzata con: n.1 cassettone con apertura maniglia a gola in M07 Titanio e ripiani in legno T166 Desert - illuminazione interna luce calda 2700 K, accensione con sensore all'apertura delle ante. Interni legno: T166 Desert cm L 575 x P 72,5 / 87,5 x H 301

EN - Milano kitchen composition with: on the left, n.2 full-height cabinets with pocket doors in slatted in wood T166 Desert and handles in M07 Titanio, equipped with: n.2 wooden drawers with M07 Titanio milling handle, compartment for built-in oven, open compartments, n.2 shelves in neutral extra-clear glass - internal lighting, warm light 2700 K, switching on/off with doors opening. On the right, of a tall unit with n.2 full-height cabinets with pocket doors in slatted in wood T166 Desert and handles in M07 Titanio, equipped with: n.1 wooden drawers with M07 Titanio milling handle and wooden shelves T166 Desert - internal lighting warm light 2700 K, switching on/off with doors opening. Interiors in wood: T166 Desert cm L 575 x P 72,5 / 87,5 x H 301



KITCHEN

ARMADIO LINE CON ANTE BATTENTI IN  
LEGNO FINITURA CALCE BIANCO  
E ILLUMINAZIONE LED INTEGRATA  
VERTICALE / LINE WARDROBE  
WITH HINGED DOORS IN WOOD  
FINISH CALCE BIANCO AND  
INTEGRATED VERTICAL LED LIGHTING







IT - Armadio Line con struttura ed interni in legno T166 Desert, tamponamento e zoccolo in legno M07 titanio, ante battenti in legno finitura Calce col.bianco. Illuminazione led integrata verticale, luce calda 2700K. Interni: ripiani in legno e predisposizione per frigorifero. Illuminazione led interna, luce calda 2700K. cm L 480 x P 62/68 x H 297

EN - Line wardrobe with structure and interiors in wood T166 Desert, upper infill and plinth in wood M07 titanio. Hinged doors in wood finish Calce col.bianco. Integrated vertical led lighting 2700K warm white. Inside: wooden shelves and space for fridge. Integrated led lighting 2700K warm white cm L 480 x W 62/68 x H 297





DETTAGLIO INTERNI ARMADIO LINE  
CON RIPIANI IN LEGNO E FRIGORIFERO.  
ILLUMINAZIONE LED INTERNA / DETAILS INSIDE  
THE WARDROBE LINE WITH WOODEN SHELVES  
AND FRIDGE. INTERNAL LED LIGHTING.





## KITCHEN

IT - Sistema componibile Vogue con struttura ed interni in legno T166 Desert, 3 ante battenti con venatura verticale su fascia superiore e venatura orizzontale su fascia inferiore in legno T166 Desert, maniglie in metallo M07 titanio. Illuminazione interna verticale led, luce calda 2700K. Vano a giorno con schienale in acciaio, mensole in legno rivestite in marmo Breccia Capraia levigato. Illuminazione orizzontale bidirezionale led, luce calda 2700K cm L 322 x P 45 x H 297.

EN - Vogue day system with structure and interiors in wood T166 Desert, 3 hinged doors in wood T166 Desert with vertical veneer on the upper part and horizontal veneer in the lower part, handles in metal M07 titanio. Integrated vertical led lighting 2700K warm white. Open compartment with back in steel, wooden shelves lined with marble Breccia Capraia honed, horizontal bidirectional led lighting 2700K warm white cm L 322 x W 45 x H 297.



# TECHNICALS

## SHAKE DESIGN TECHNICAL DATA

IT - Un'esplorazione accurata e approfondita delle caratteristiche dei prodotti Shake utile alla progettazione dei vostri spazi.

*EN - A careful and deepened research in Shake products features, helps in designing your spaces.*

**SEDUTE SEATING**

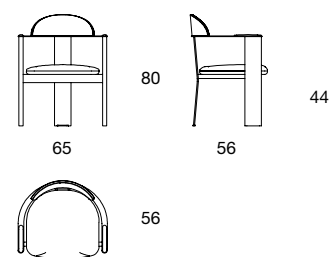

**EGO**  
sedia, chair  
p. 34, 36-37, 38-39, 41

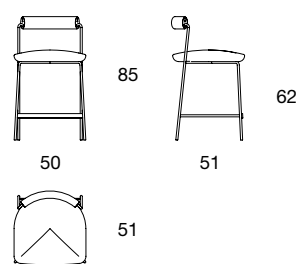

**FRAME**  
sgabello, stool  
p. 88-89, 91, 92, 93

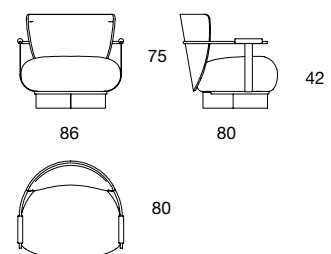

**FUN**  
poltrona, armchair  
p. 22, 27, 28, 29, 86, 87

**DIVANI SOFAS**

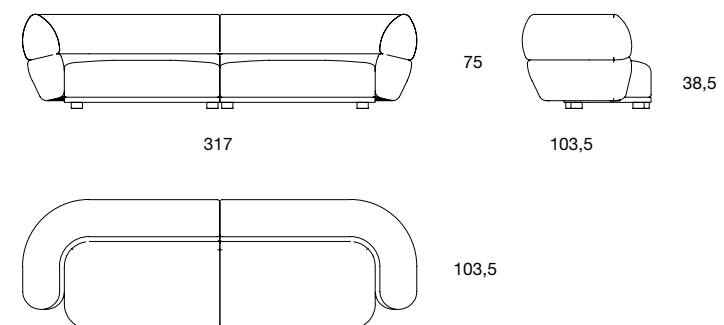

**VOGUE**  
divano, sofa  
p. 8, 9, 10, 12

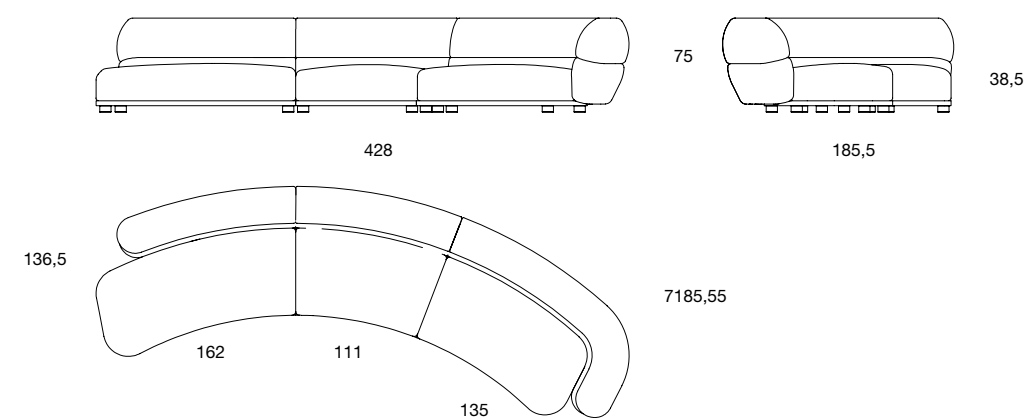

**VOGUE**  
divano curvato, curved sofa  
p. 8, 9, 10, 12

**TAVOLINI COFFEE TABLES**

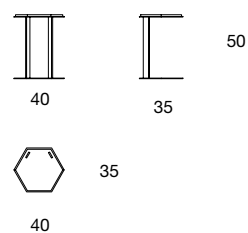

**HEX**  
tavolino, coffee table  
p. 96-101

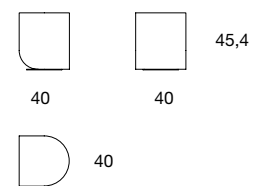

**NO NAME**  
tavolino, coffee table  
p. 96-101

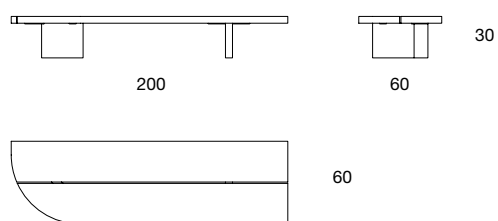

**EGO**  
tavolino elemento 1, coffee table element 1  
p. 96-101

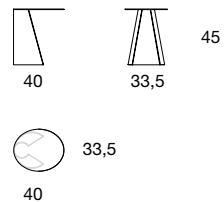

**VICTOR**  
tavolino, coffee table  
p. 68, 71, 76

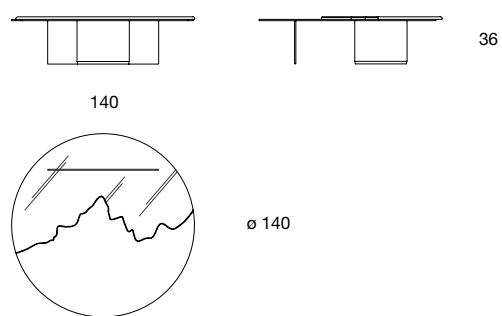

**CAPRI**  
tavolino, coffee table  
p. 96-101

**TAVOLI TABLES**

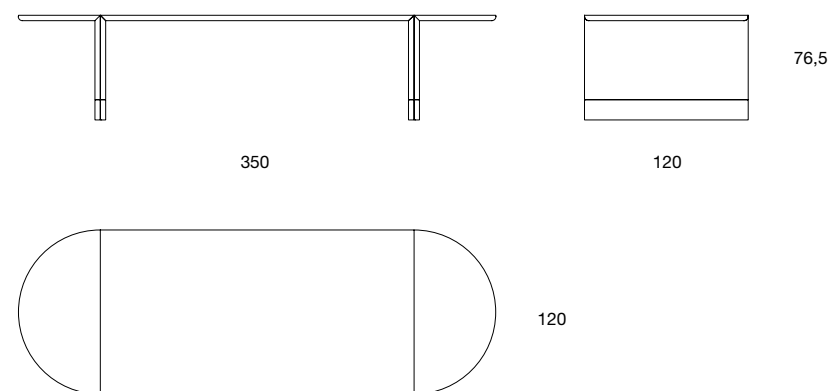

**MAYFAIR**  
tavolo ovale, oval table  
p. 88-89, 98, 100, 101, 102-103, 104-105

**MADIE SIDEBOARD**

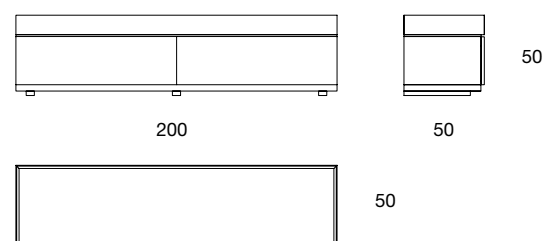

**MAYFAIR**  
sistema giorno, bases  
p. 78-79, 80, 81, 82, 83

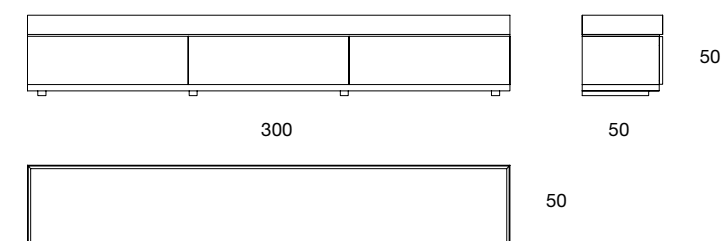

**MAYFAIR**  
sistema giorno, bases  
p. 78-79, 80, 81, 82, 83

**SISTEMI GIORNO DAY SYSTEM**

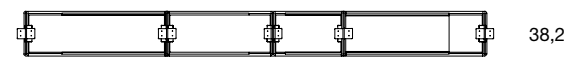
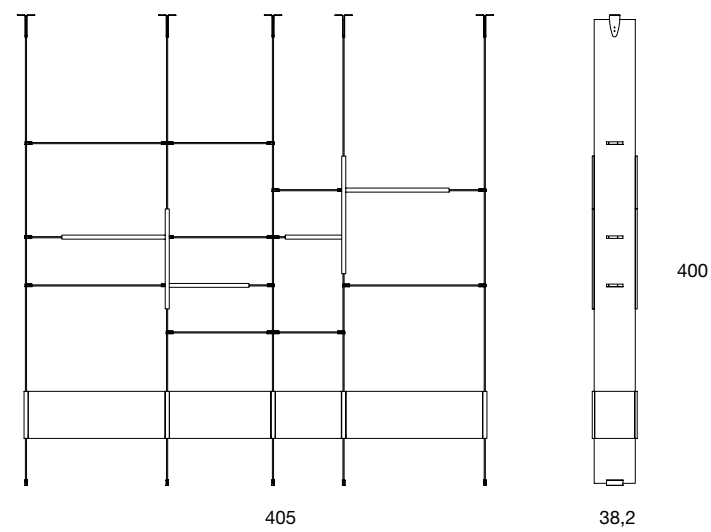

**TIME**  
libreria, bookshelf  
p. 68-69, 71, 85

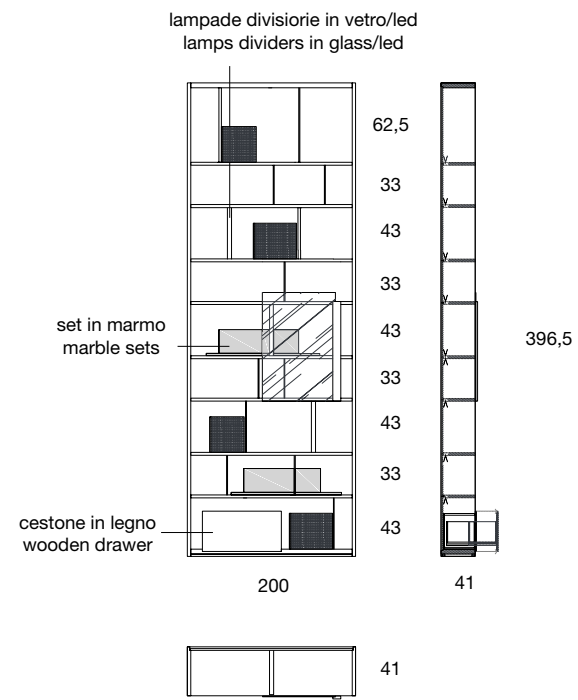

**ELLE**  
sistema giorno, day system  
p. 81-85

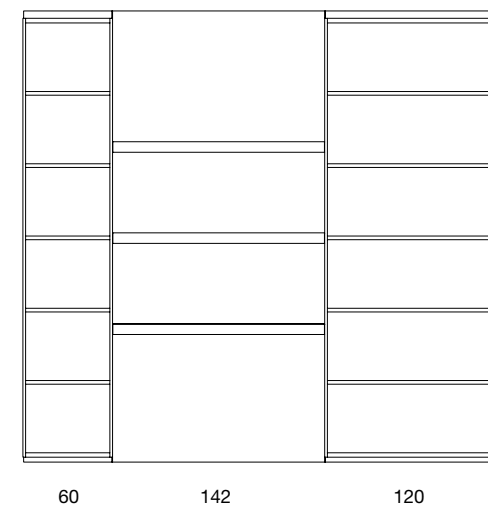
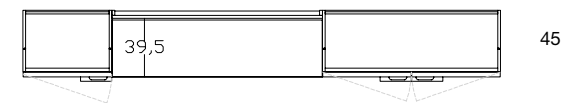
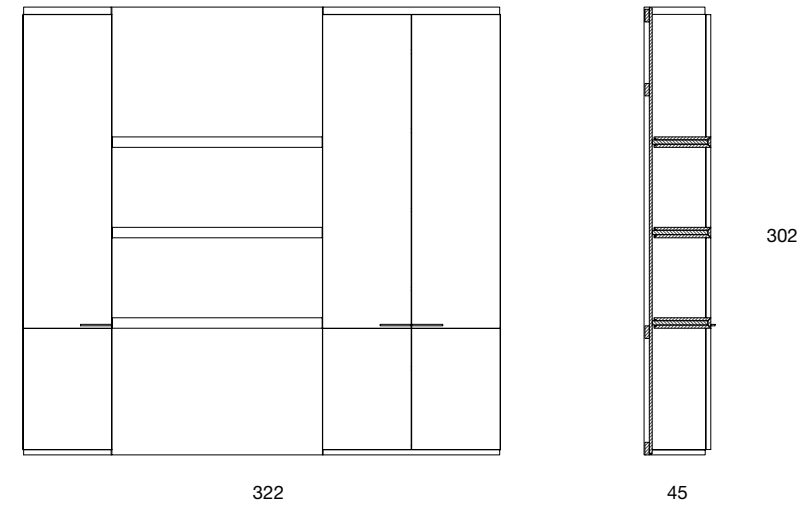

**VOGUE**  
sistema componibile, day system  
p. 81-85

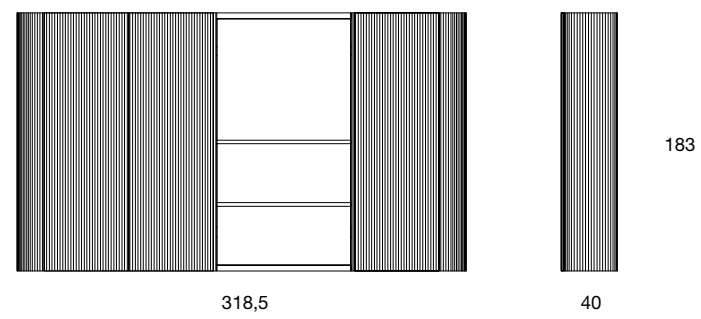

**HEGE**  
libreria pensile, wall-hanging bookcase  
p. 68-69, 71, 85



**CUCINA KITCHEN**

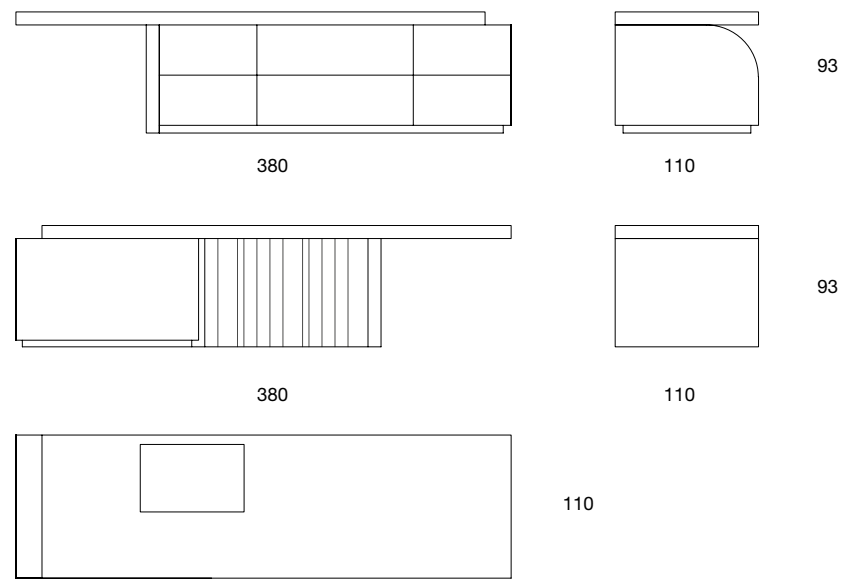

**MILANO**  
isola  
p. 81-85

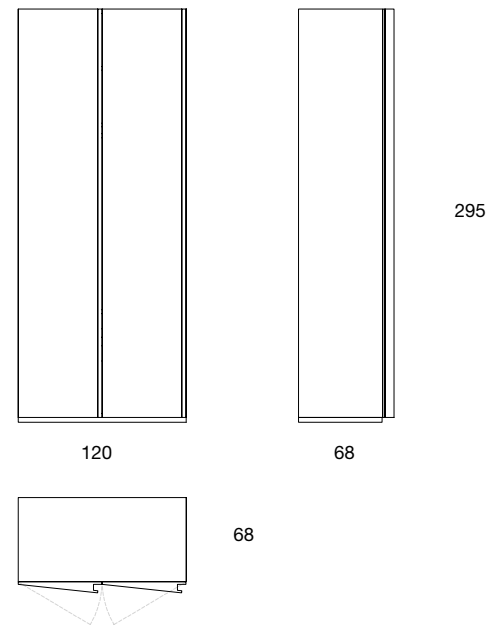

**LINE**  
armadio, wardrobe  
p. 81-85

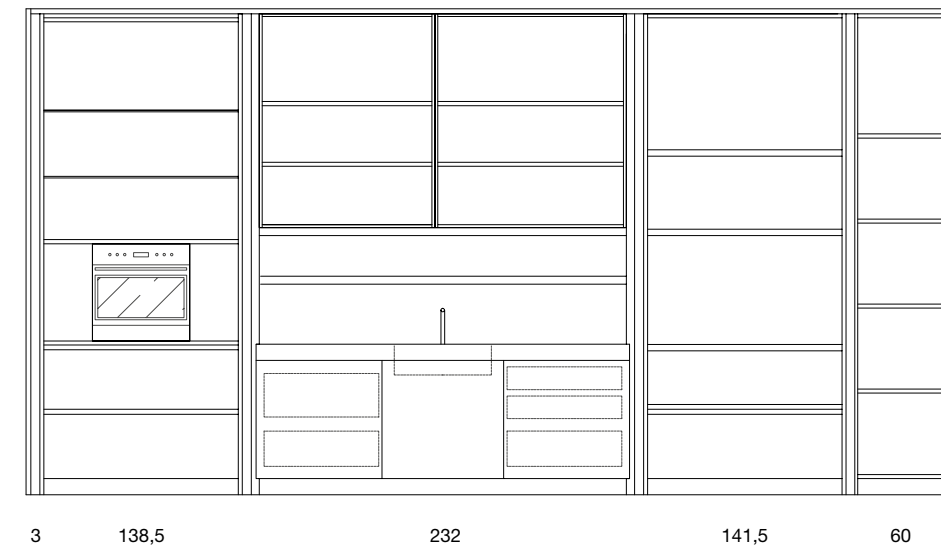
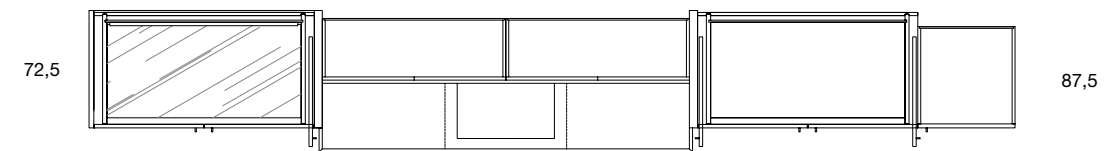
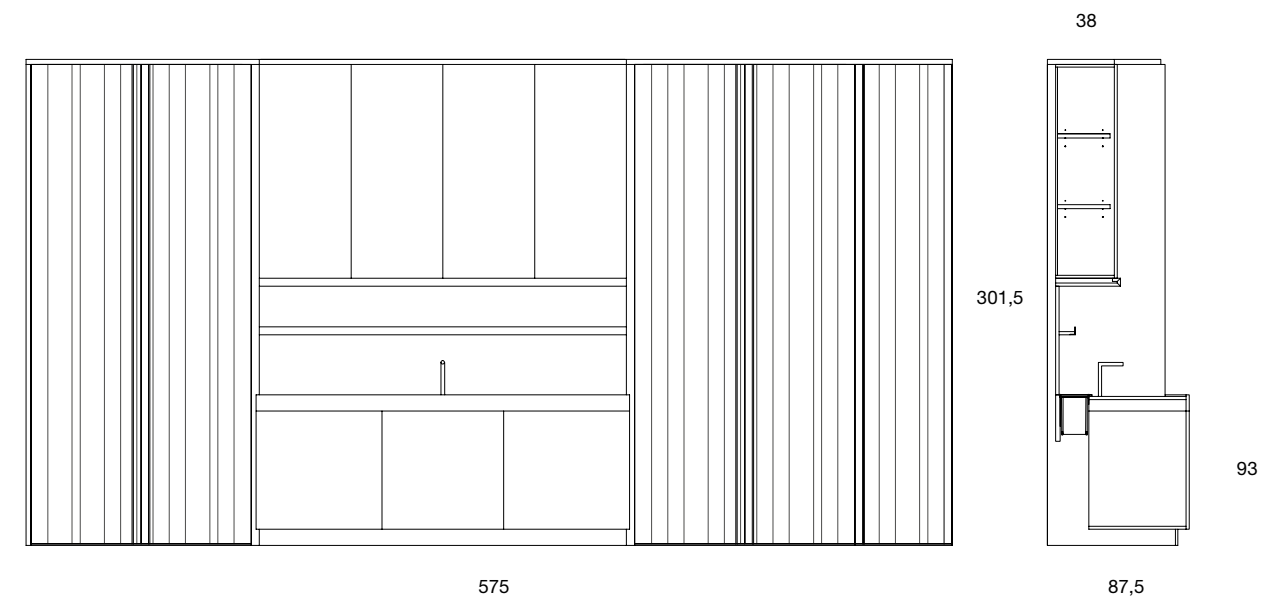

**MILANO**  
cucina, kitchen  
p. 88-89, 91



## LAMPADE LAMPS

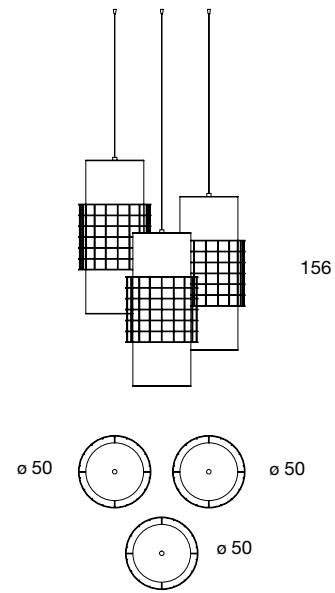

**CAGE**  
lampada a sospensione, ceiling lamp  
p. 34, 37, 41

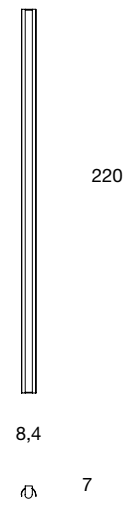

**LINE**  
lampada, lamp  
p. 34, 37, 41

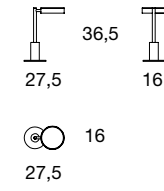

**WEVE**  
lampada da tavolo, table lamp  
p. 96-101

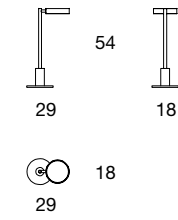

**WEVE**  
lampada da tavolo, table lamp  
p. 96-101

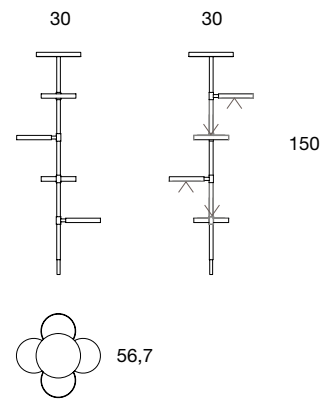

**WEVE**  
lampada a sospensione, ceiling lamp  
p. 57, 58, 59, 60, 63

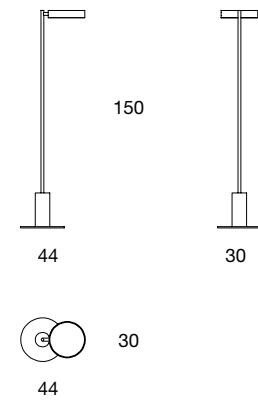

**WEVE**  
lampada da terra, floor lamp  
p. 4, 9, 10, 11, 34, 49, 92, 179, 199

## SPECCHI MIRRORS

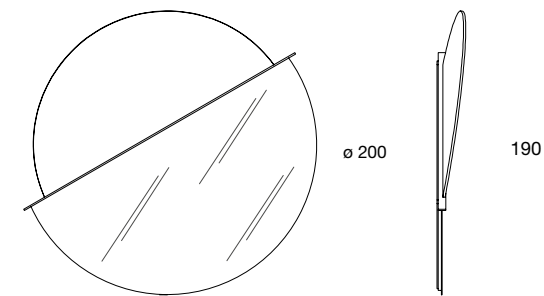

**MOON**  
specchio, mirror

# FINISHES

## SHAKE DESIGN FINISHES

IT - La palette di materiali Shake è concepita per consentire sempre nuovi accostamenti e creare progetti unici e sorprendenti.  
*EN - Shake materials palette is designed to allow new combinations and create unique and surprising projects.*

## FINITURE FINISHES

### TINTE "T" / PAINTS "T"

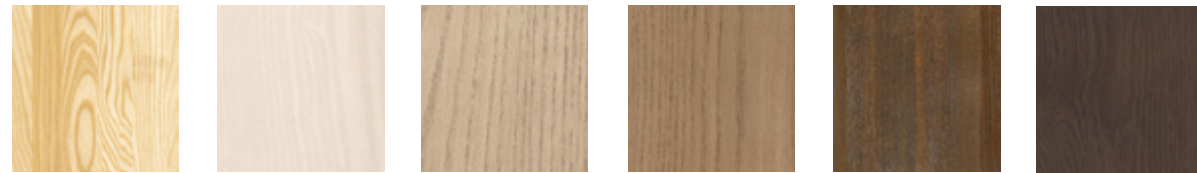

T32 natural T34 wealth T159 nocciola T158 biscotto T22 moka T160 cioccolato

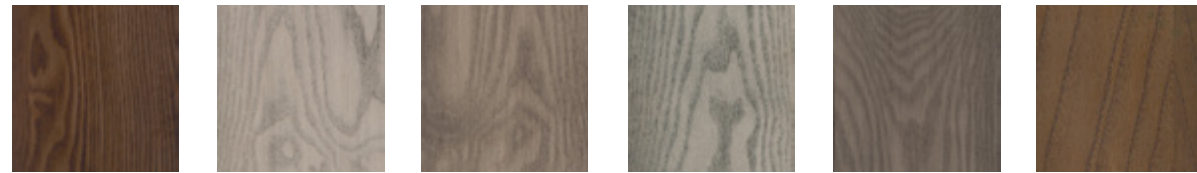

T46 tinta noce T49 cenere T50 grigio Londra T41 grey T152 sabbia T42 brown



T44 land T151 terra T37 wengè T150 noir T161 dark T47 ardesia sfumata T166 Desert

### LACCATI COPRENTI "C" / COVERING LACQUERED "C"



C12 bianco C154 bianco caldo C49 tortora C23 giallo relax C59 arancio bruciato C58 rosso nepal C155 marsala



C62 verde oliva C33 turquoise C63 carta da zucchero C27 blu cannes C66 prugna versilia C40 testa di moro C14 nero

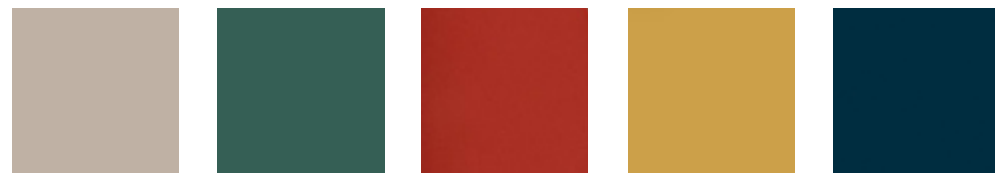

C81 grigio Jersey C162 verde C163 rosso corallo C164 senape C165 petrolio

### LACCATI SPAZZOLATI CON MORCIA "S" / BRUSHED LACQUERED WITH PATINA "S"

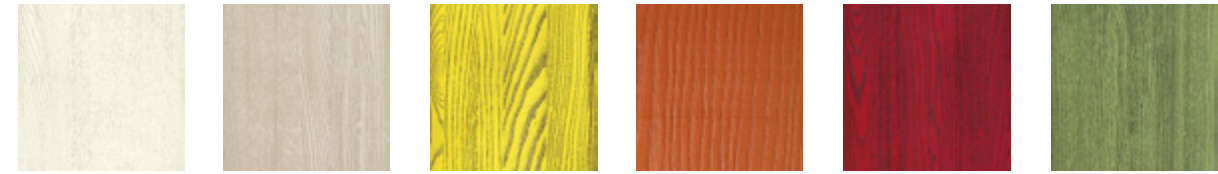

S12 bianco S49 tortora S23 giallo relax S59 arancio bruciato S58 rosso nepal S62 verde oliva



S33 turquoise S63 carta da zucchero S27 blu cannes S66 prugna versilia S39 lavagna S14 nero

### METALLI "M" / METALS "M"



M06 Ottone brunito M03 bronzo chiaro M02 bronzo scuro M01 rame M07 titanio M04 nero

### FINITURE SPECIALI "X" / SPECIAL FINISHES "X"

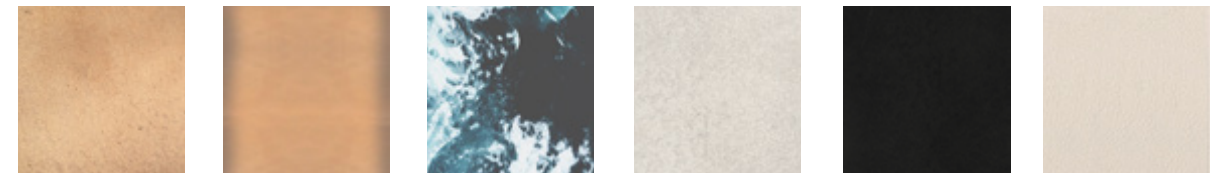

X48 bronzo chiaro X80 resina lucida grigio sfumato X85 Giò X82 concrete bianco X84 concrete nero X86 argilla

X87 calce col.terra X88 calce col.seta X89 calce col.bianco

### VETRI / GLASSES



extrachiaro / extraclear bronzo / bronze fumè / smoked

**PELLI "P" / LEATHER "P"**

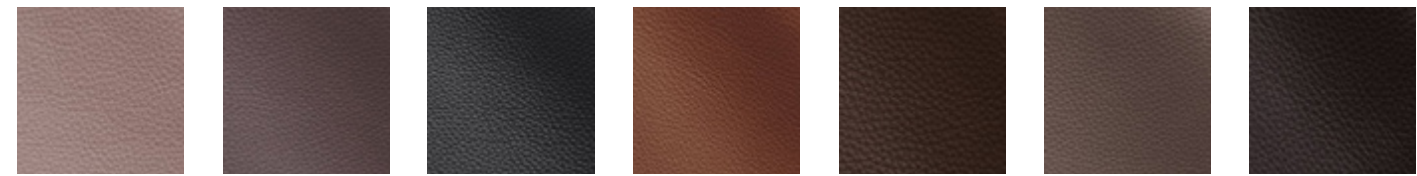

P48 set col. 9018 bird cat. A  
 P49 set col. 9022 minerale cat. A  
 P50 set col. 9033 pepe cat. A  
 P51 set col. 9006 teak cat. A  
 P54 set col. 9011 cacao cat. A  
 P56 set col. 9020 tartufo cat. A  
 P57 set col. 9032 fondente cat. A



P24 rustik nabuk col. 31 creta cat. B  
 P23 rustik nabuk col. 600 sabbia cat. B  
 P22 rustik nabuk col. 630 cioccolato cat. B  
 P39 rustik nabuk col. 605 tortora cat. B  
 P21 rustik nabuk col. 655 crema cat. B  
 P32 rustik nabuk col. 660 ambra cat. B  
 P33 rustik nabuk col. 635 antracite cat. B

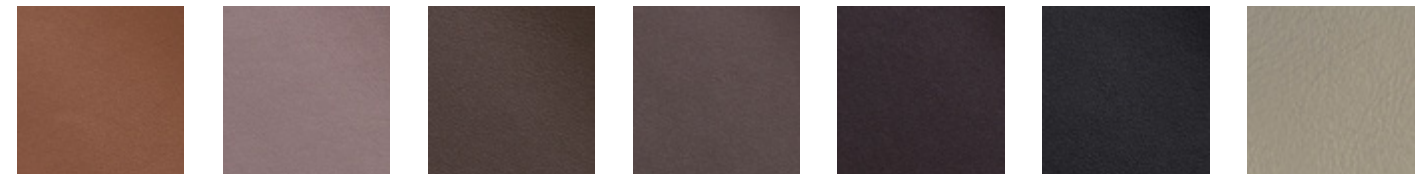

P70 lat col. 8030 honey cat. B  
 P71 lat col. 8010 cremino cat. B  
 P72 lat col. 8050 tundra cat. B  
 P73 lat col. 8060 vimini cat. B  
 P74 lat col. 8070 tronco cat. B  
 P75 lat col. 8080 lavico cat. B  
 P76 soft col. 2306 cat. B



P77 soft col. 2302 cat. B  
 P78 soft col. 2300 cat. B  
 P90 amal col. 315 cat. C

**SET:** Pelle mezzo fiore, grana naturale con mano morbida e tatto segoso con protezione idrorepellente superficiale.  
 A homogenous, natural, half-grain leather, characterized by unique soft touch with waterproof surface treatment.

**RUSTIK NABUK:** Nabuk grana naturale, rifinito con una cera per creare l'effetto leggermente invecchiato.  
 Natural grain nubuck, finished with a wax to create the slightly aged effect.

**LAT:** Pelle pieno fiore, semianilina protetta sottovuoto, aspetto liscio con protezione idrorepellente superficiale.  
 Full-grain leather, vacuum protected half-aniline, smooth appearance with waterproof surface treatment.

**SOFT:** Pelle mezzo fiore, dall'aspetto nabuccato, superficie liscia, opaca e morbida. Pelle dalle alte caratteristiche tecniche, resistente allo sporco, all'abrasione e facilmente pulibile.  
 Half-grain leather with nubuk appearance, smooth, matt and soft surface. Leather with superior technical characteristics, resistant to dirt, abrasions and easy to clean.

**NABUK:** Pelle pieno fiore, grana sottile, nabuccato con protezione idrorepellente superficiale.  
 Full grain leather, fine grain, nubuk with waterproof surface treatment.

**MED:** Pelle anilina con protezione idrorepellente superficiale.  
 Aniline leather, with waterproof surface treatment.

**Le pelli sono di origine Europe e provengono da allevamenti di bovini i quali vengono trattati con cura, crescendo in ambienti sostenibili, tutelandone la salute e benessere.**  
 The leather are of European origin and come from farms for food purposes in which the cattle are kept with care, growing in sustainable livestock environments, protecting their health and also skin care.

**PELLI "P" / LEATHER "P"**



P20 nabuk col. seppia cat. D  
 P20S nabuk spighetta col. seppia cat. D  
 P20T nabuk traforato col. seppia cat. D  
 P38 nabuk col. 6 grey cat. D  
 P38P nabuk pois col. 6 grey cat. D  
 P30 nabuk col. 24 verde bosco cat. D  
 P46 nabuk col. blu oceano cat. D

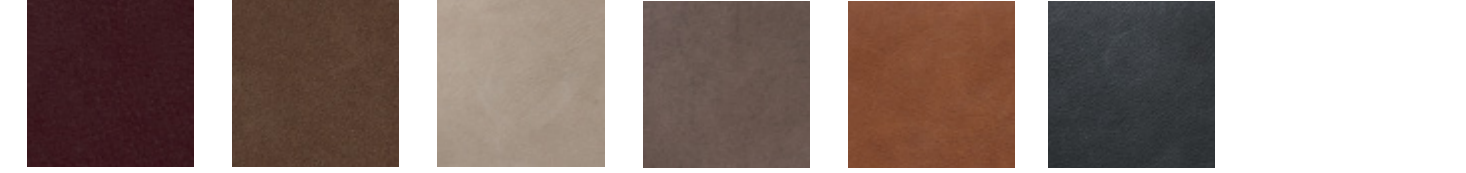

P52 nabuk col. 8424 marsala cat. D  
 P61 nabuk col. 8406 caramello cat. D  
 P42 med col. 8 cat. D  
 P44 med col. 18 cat. D  
 P43 med col. 14 cat. D  
 P36 med col. 1 cat. D

**TESSUTI "F" / FABRIC "F"**



F10 TGA col. 1849 Blanc  
 F11 TGA col. 0217 Maron glacè  
 F12 TGA col. 2257 Perle  
 F13 TGA col. 0421 Toupè  
 F14 TGA col. 0727 Noir de Lune  
 F15 TGA col. 1135 Vert Sapin  
 F16 TGA col. 1339 Ocre



F17 TGA col. 2359 Ambre  
 F18 TGA col. 1645 Bois de Rose  
 F30 NPL col. 0357 Creme  
 F31 NPL col. 0456 Grege  
 F32 NPL col. 1842 Ambre  
 F33 NPL col. 2040 Vert Sapin  
 F34 NPL col. 2238 Marine

**GRES / STONEWARE**



G01 Pietra Grey Lucido / Polished  
 G02 Calacatta Oro Lucido / Polished  
 G03 Sahara Noir Lucido / Polished

**MARMI / MARBLES**



MAR01 Pietra Grey Lucido / Polished  
 MAR02 Bianco di Carrara Lucido / Polished  
 MAR03 Nero Marquinia Lucido / Polished  
 MAR05 Travertino  
 Breccia Capraia

# MODERN COMPANY

## SHAKE DESIGN COMPANY PROFILE

*IT - Partendo dall'equilibrio tra funzione e forma, stile e comfort, lusso e rigore Shake crea con questi valori un design contemporaneo ridefinendo e reinventando materiali, tecniche e forme.*

*EN - Aiming to balance, function and shape, style and comfort, luxury and rigour, Shake signs a contemporary concept of design that redefines and reinvents materials, techniques and outlines.*

# LUXURY CRAFTSMANSHIP



IT - Creatività, ricerca, attenzione al dettaglio rappresentano le linee guida e i principi di ideazione e costruzione nella realizzazione di ciascun progetto. I prodotti shake presentano funzionalità e qualità dei materiali che favoriscono la loro durata nel tempo e vengono realizzati con tecnologie efficienti che rispettano l'ambiente. La produzione artigianale del made in italy supera la logica del prodotto standardizzato e garantisce un elevato livello di personalizzazione.

*EN - Creativity, research and attention to detail represent the guidelines and principles of design and construction for the realisation of each project. Shake products feature functionality and quality of materials which enhance their longevity and that are built using efficient and eco-friendly technologies. Handcrafted production of made in italy overcome the idea of standardised product ensuring a high level of customization.*





# MADE IN ITALY INTERNATIONAL VISION

IT - Shake crea prodotti funzionali, contemporanei e con uno stile inconfondibile, in grado di conciliare la più alta tradizione artigianale con l'impiego di sofisticate tecnologie produttive di ultima generazione. Il risultato é un progetto made in italy, che coglie le esigenze e i gusti di un pubblico internazionale.

*EN - Shake creates both functional and contemporary items with a unique style, which are able to conciliate the highest artisan tradition with the use of sophisticated production technologies. The result is a made in italy project gathering needs and tastes of an international audience.*



Design Andrea Zonta  
Art Direction & Styling Bruno Tarsia Studio  
Photo Lorenzo Pennati  
Graphic Design Lorenzo De Grandis  
Printing Biblos

Thanks to  
Blomus  
Gardeco  
Gioderico  
Novocquadro  
Sensebynvd

**Shake**  
via Pertini, 37  
sede operativa: via Sturzo, 10  
Tezze sul Brenta (VI) Italy  
tel +39 0424 560213  
fax +39 0424 560761  
info@shake-design.it  
www.shake-design.it